



PLEASE READ THE ENTIRE CONTENTS OF THIS MANUAL PRIOR TO INSTALLATION AND OPERATION. BY PROCEEDING YOU AGREE THAT YOU FULLY UNDERSTAND AND COMPREHEND THE FULL CONTENTS OF THIS MANUAL. FORWARD THIS MANUAL TO ALL OPERATORS. FAILURE TO OPERATE THIS EQUIPMENT AS DIRECTED MAY CAUSE INJURY OR DEATH.

REV A 04-15-09

INSTALLATION AND OPERATION MANUAL

**ADJUSTABLE HEIGHT
PNEUMATIC TIRE
SPREADER
MODEL: TS-150**



Keep this operation manual near the machine at all times. Make sure that ALL USERS read this manual.

SHIPPING DAMAGE CLAIMS

When this equipment is shipped, title passes to the purchaser upon receipt from the carrier. Consequently, claims for the material damaged in shipment must be made by the purchaser against the transportation company at the time shipment is received.

BE SAFE

Your new Tire Spreader was designed and built with safety in mind. However, your overall safety can be increased by proper training and thoughtful operation on the part of the operator.

DO NOT operate or repair this equipment without reading this manual and the important safety instructions shown inside.



1645 Lemonwood Dr.
Santa Paula, CA. 93060, USA
Toll Free 1-800-253-2363
Tel: 1-805-933-9970
Fax: 1-805-933-9160
www.rangerproducts.com

Pneumatic Tire Spreader

WARRANTY POLICY

Ranger Products™ are backed by over 35 years of manufacturing experience. Every Tire Spreader bearing the Ranger™ name is sold with the following warranty.

- Each Ranger Product™ is warranted to be free from defects in workmanship and material for a period of one year from the date of shipment provided that a written claim for such defect is made within that time.
- This warranty does not cover damage or defects caused by carelessness of the operator, misuse, abuse or abnormal use which in any way impairs the proper functioning of the equipment or by the use or addition of parts not manufactured by Ranger Products™ or its suppliers.

THIS WARRANTY IS EXPRESSLY MADE IN LIEU OF ANY AND ALL OTHER WARRANTIES EXPRESSED OR IMPLIED INCLUDING THE WARRANTIES OF MERCHANTABILITY AND FITNESS OR A PARTICULAR PURPOSE.

If your Ranger Products™ machine is not functioning properly, call your Ranger Products™ dealer immediately. On some occasions, an independent contractor may be hired to do the repairs. Within the warranty period, a customer should not hire his own contractor unless it is authorized in writing by Ranger Products™.

If it is necessary to return equipment for repairs, your dealer will so advise you. When returning equipment for repairs, see that machines are properly crated and protected, and prepay transportation.

Defective parts replaced at no charge must be returned to your dealer or Ranger Products™ within 60 days of the date that the replacement parts are shipped; otherwise, you must pay for the replacement parts at the current selling price.

OPERATOR PROTECTIVE EQUIPMENT

Personal protective equipment helps keep equipment use safer. However, equipment does not take the place of safe operating practices. Always wear durable work clothing. Shop aprons or shop coats may also be worn, however loose fitting clothing should be avoided. Tight fitting leather gloves are recommended to protect operators. Sturdy leather work shoes with steel toes and oil resistant soles should be used by personnel to help prevent injury in typical shop activities.

Eye protection is essential during installation and operation. Safety glasses with side shields, goggles, or face shields are acceptable. Back belts provide support during lifting activities and are also helpful in providing operator protection. Consideration should also be given to the use of hearing protection if activity is performed in an enclosed area, or if noise levels are high.



OWNER'S RESPONSIBILITY

To maintain machine and user safety, the responsibility of the owner is to read and follow these instructions:

- ◆ Follow all installation instructions.
- ◆ Make sure installation conforms to all applicable Local, State, and Federal Codes, Rules, and Regulations; such as State and Federal OSHA Regulations and Electrical Codes.
- ◆ Carefully check the unit for correct initial function.
- ◆ Read and follow the safety instructions. Keep them readily available for machine operators.
- ◆ Make certain all operators are properly trained, know how to safely and correctly operate the unit, and are properly supervised.
- ◆ Allow unit operation only with all parts in place and operating safely.
- ◆ Carefully inspect the unit on a regular basis and perform all maintenance as required.
- ◆ Service and maintain the unit only with authorized or approved replacement parts.
- ◆ Keep all instructions permanently with the unit and all decal's on the unit clean and visible.

TOOLS / SUPPLIES REQUIRED

Adjustable wrench or metric open end/combination wrenches, Teflon tape, hammer, drill and bit.
(Quick disconnect Air fitting to match your air source. concrete anchors, not supplied)

UNPACKING INSTRUCTIONS

⚠ CAUTION

1. Use caution when unbolting or unstrapping from shipping pallet. Components are heavy and may have shifted during shipping.

ASSEMBLY INSTRUCTIONS

1. Attach the Ramp to the front Roller Bracket Assembly using the snap rings.

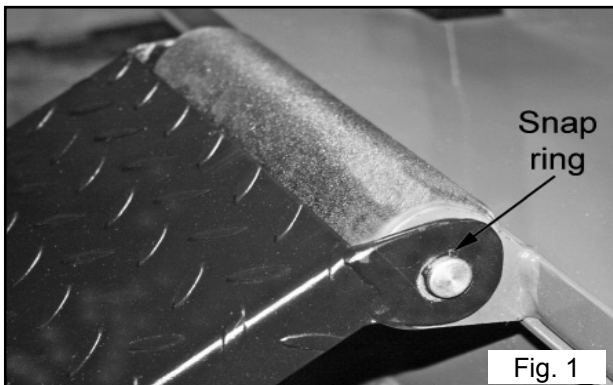

2. Position the Model on a solid level floor. Bolting it to the floor is recommended.

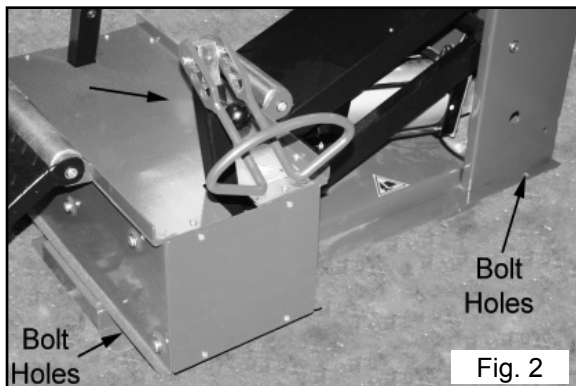

3. Insert a 1/4 NPT quick coupler nipple (not provided) through one of the holes in the side of the control tower at the base into the fitting located on the end of the air hose. Connect the fitting to the air line on the inside of the tower using Teflon tape. Be sure the air line is clear of any moving parts on the inside of the tower.

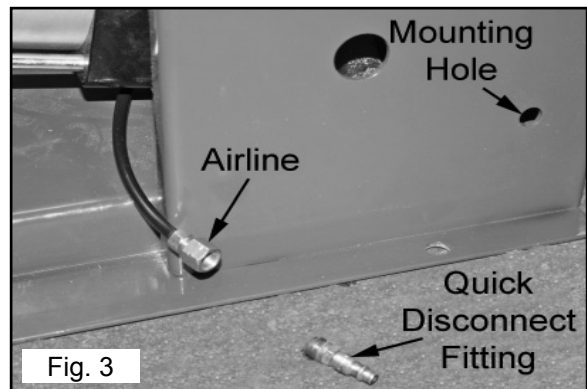

⚠ CAUTION

AN AIR LINE DRYER MUST BE USED ON THE AIR SUPPLY LINE. FAILURE TO DO SO WILL VOID WARRANTY AND DAMAGE AIR CYLINDER, VALVES AND FITTINGS.

4. Connect air supply line using 1/4 inch air hose with 125 -175 p.s.i. maximum.

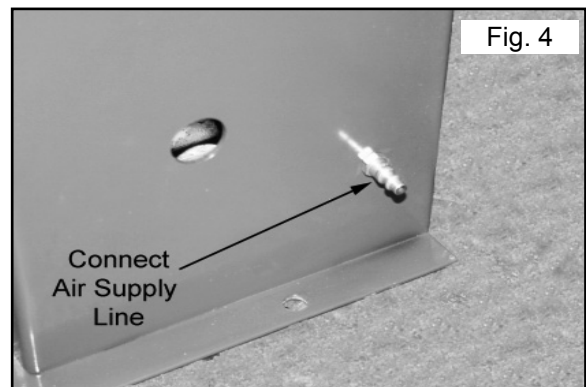

OPERATION INSTRUCTIONS

1. Make sure the spreader platform is in the lowest position.

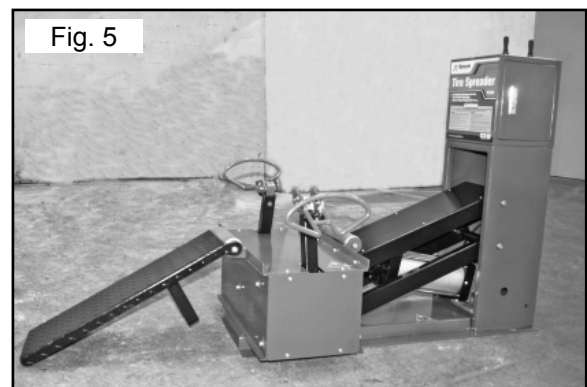

3. Pull the Spreader Hook Arms out into the open position.

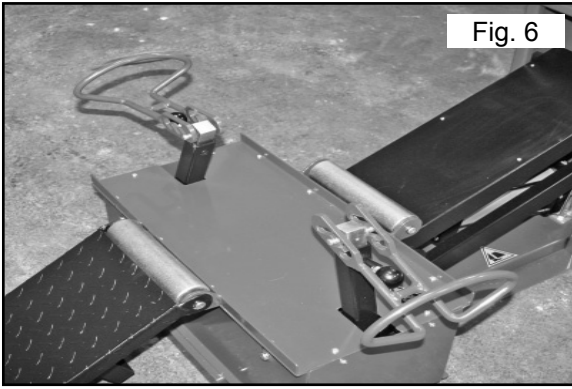

4. Roll the tire up the ramp and onto the spreader platform rollers. Steady tire with hand and insert spreader hooks between tire beads.

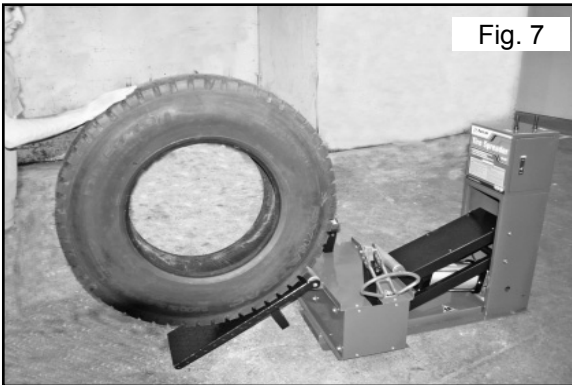

5. Adjust spreader hooks to proper height for the tire size being repaired. The spreader hook arms are held in position with a hitch pin. To adjust the spreader hook arms, pull the hitch pin and move spreader hook arm up or down to one of the four adjustment holes. Most larger truck tires will use the uppermost adjustment holes. Both spreader hook arms must be adjusted to the same height.

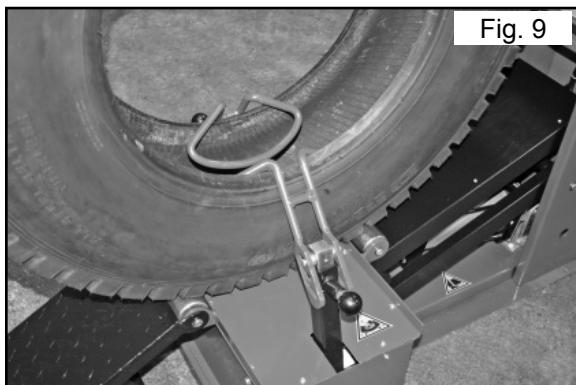
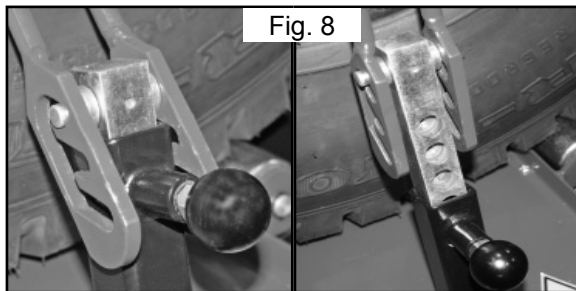

6. Spread tire to desired width using the Spreader Control Valve..

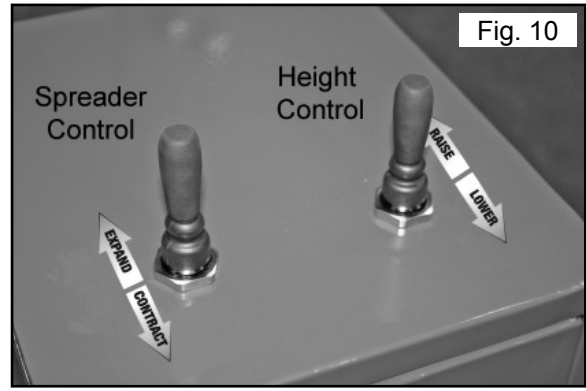

NOTE:

If tire is lifted off tire rollers when it is spread, the spreader hook arms are positioned too high and should be lowered.

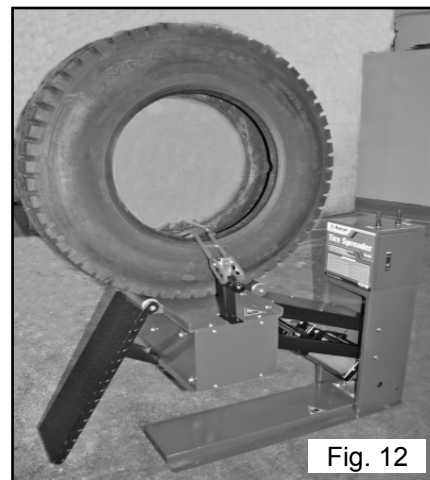

7. Raise the spreader platform to comfortable working height using the Height Control Valve.
8. After tire repairs are complete, ensure area is clear of tools hands clothing, lower the spreader platform to lowest position.
9. Release spread hook arm pressure and remove spread hook arms from the tire bead.
10. Standing at the end of the ramp, pull the tire down the ramp using both hands.

CARE AND MAINTENANCE

1. Grease rollers with light weight oil.
2. Keep Tire Spreader clean of dirt and debris.

TECHNICAL SPECIFICATIONS

- Power Supply: Full Pneumatic
- Working Pressure: Max PSI/ Range / 125 - 175 PSI
- Maximum Tire Weight: 220 lbs. / 100kgs
- Shipping Weight: 600 lbs. / 273 kgs

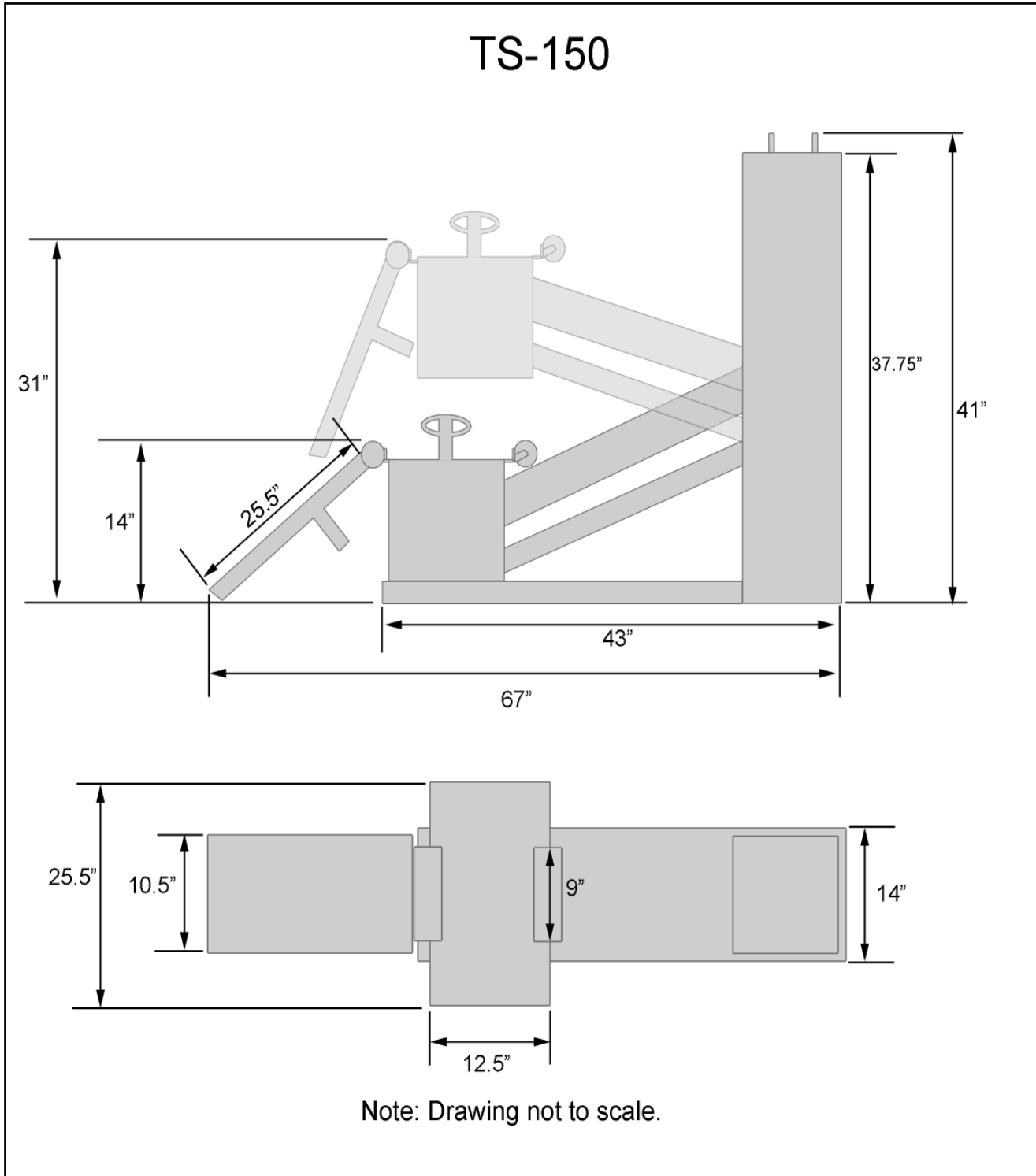

PARTS BREAKDOWN

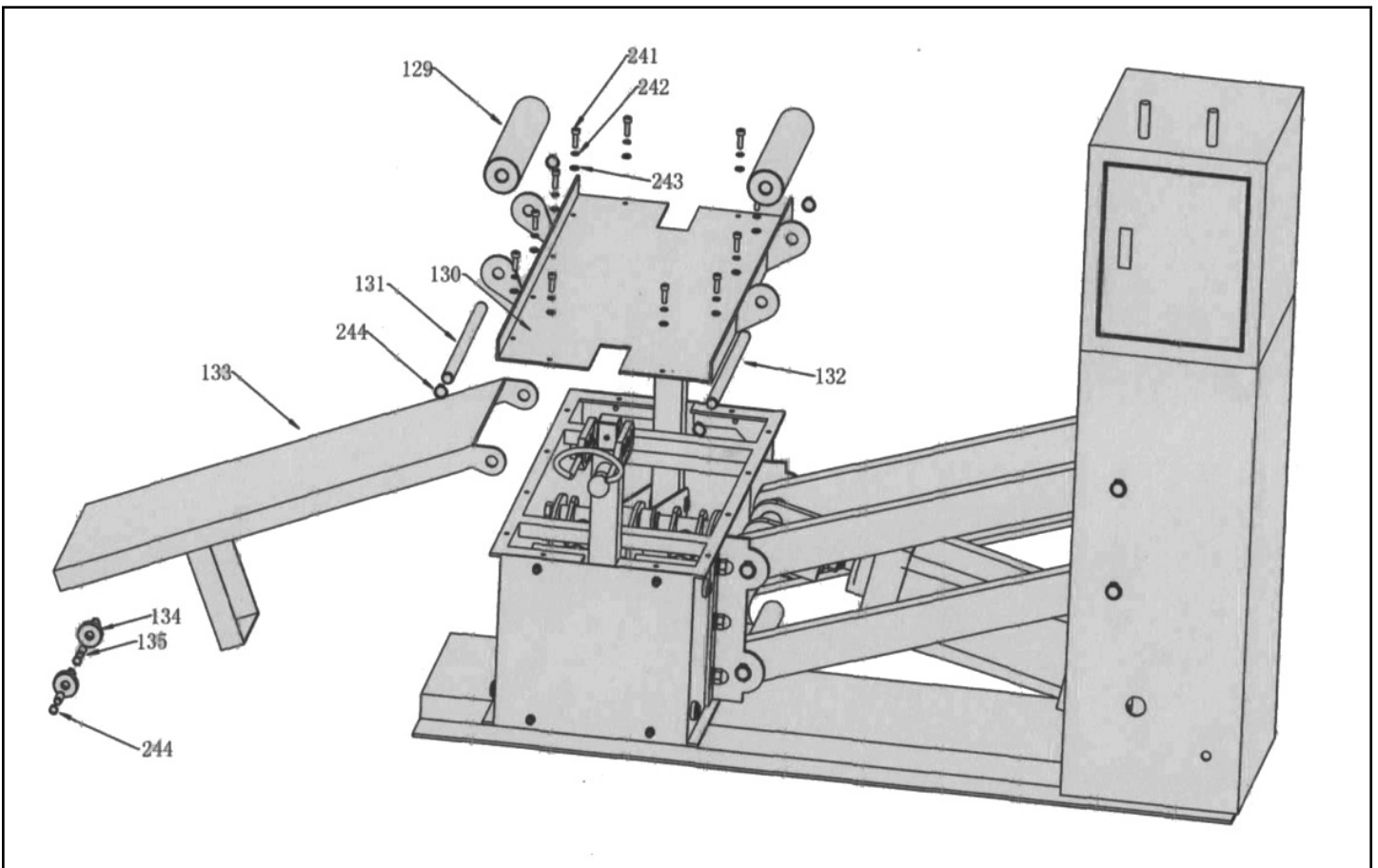
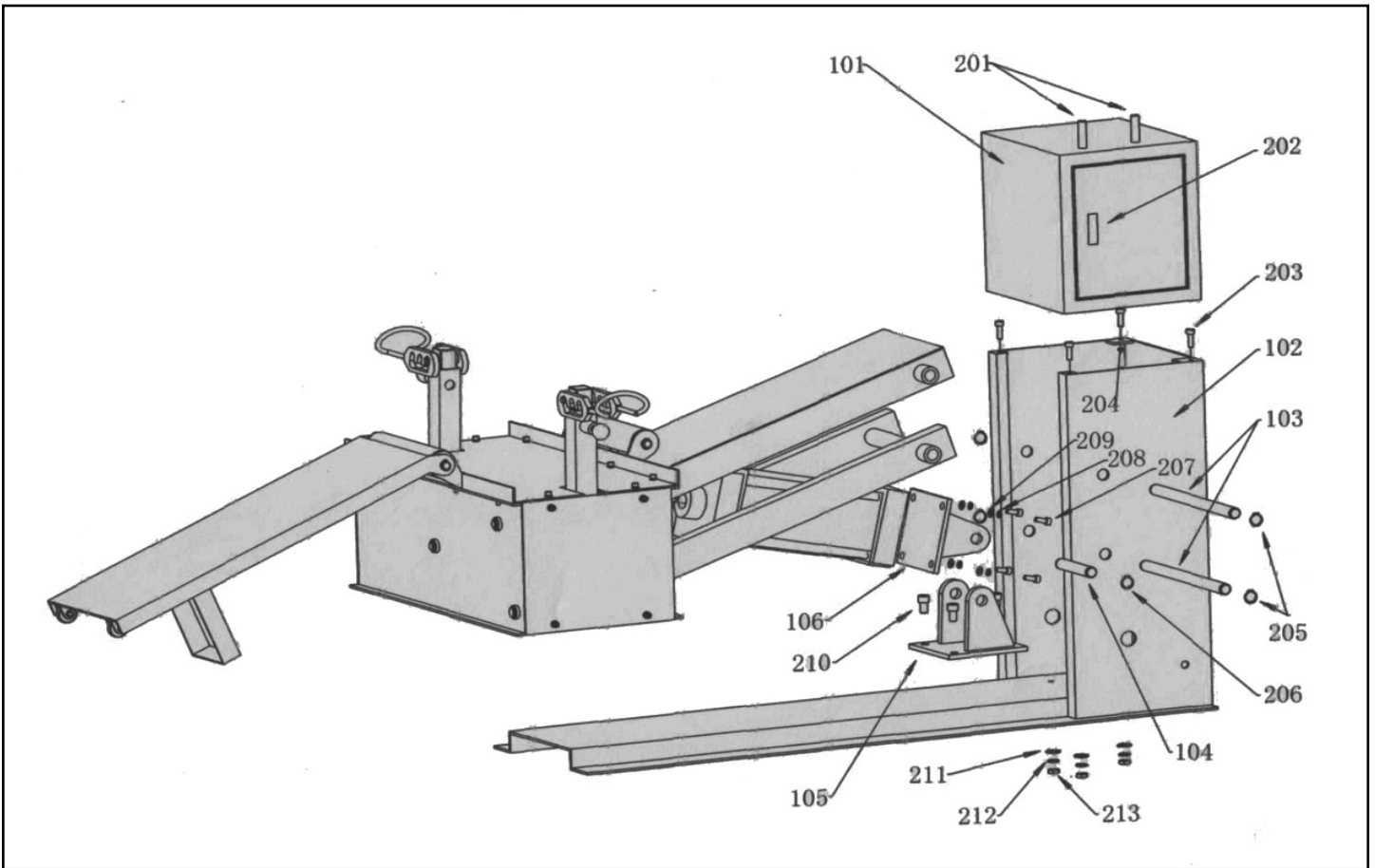

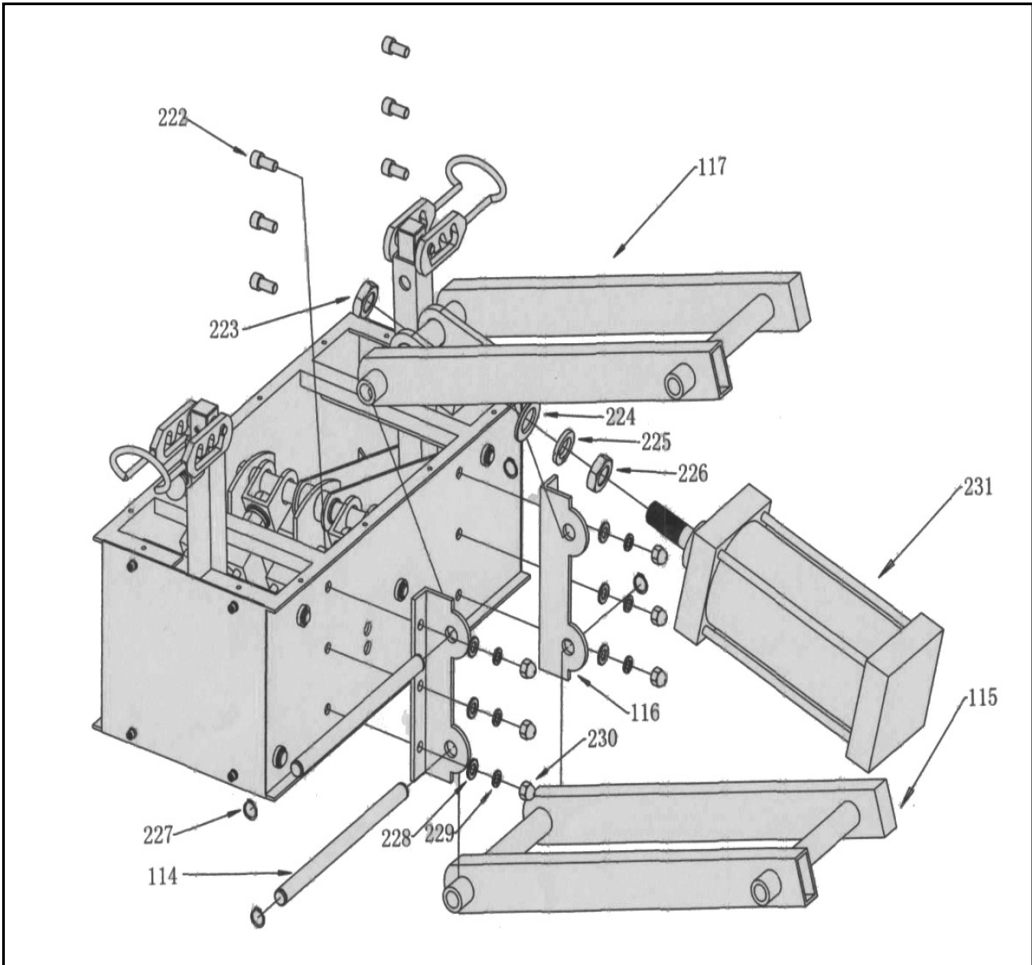
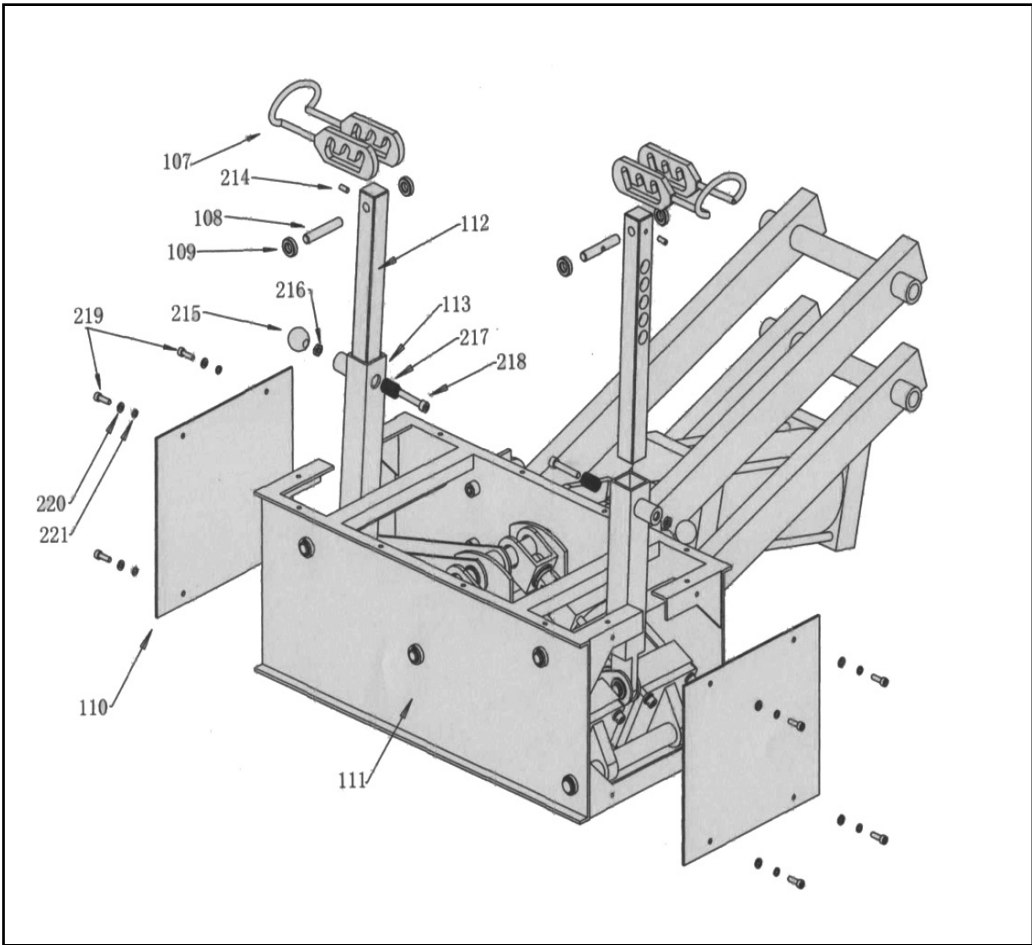

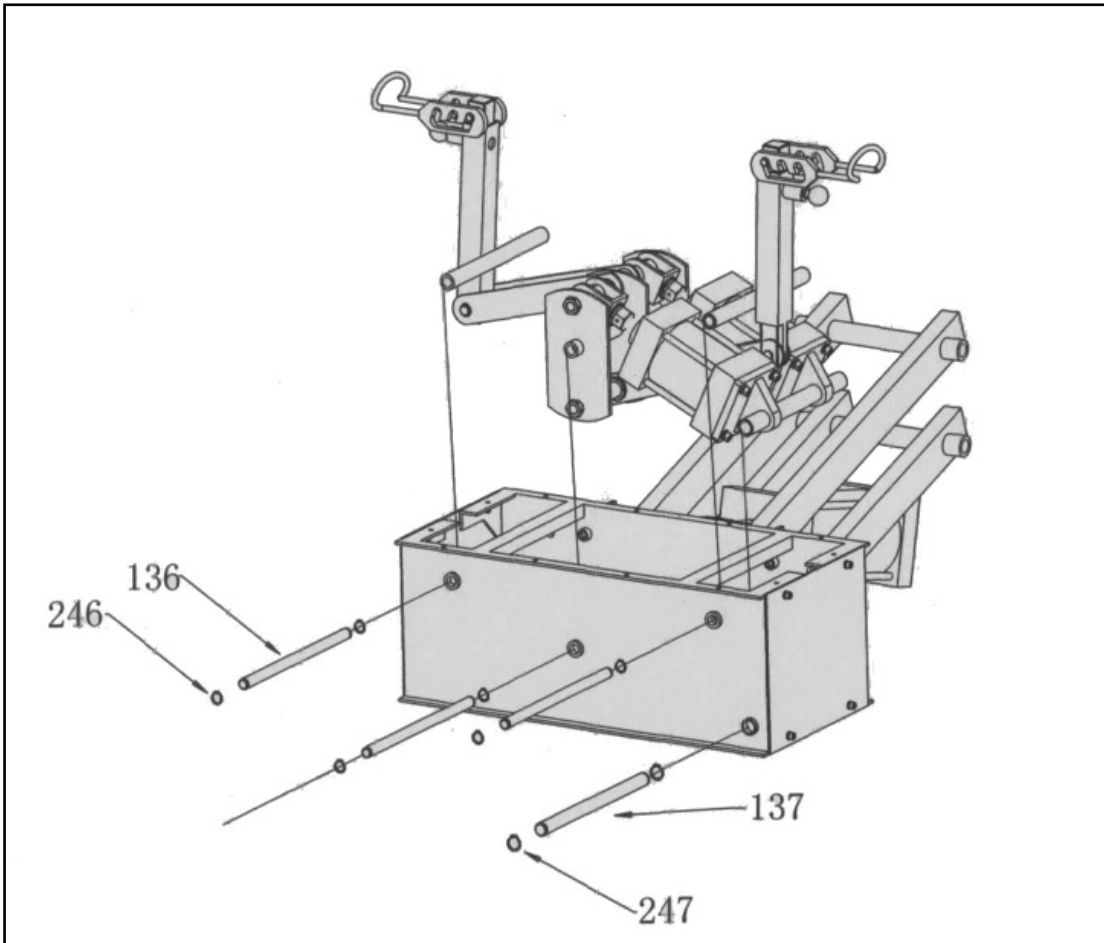
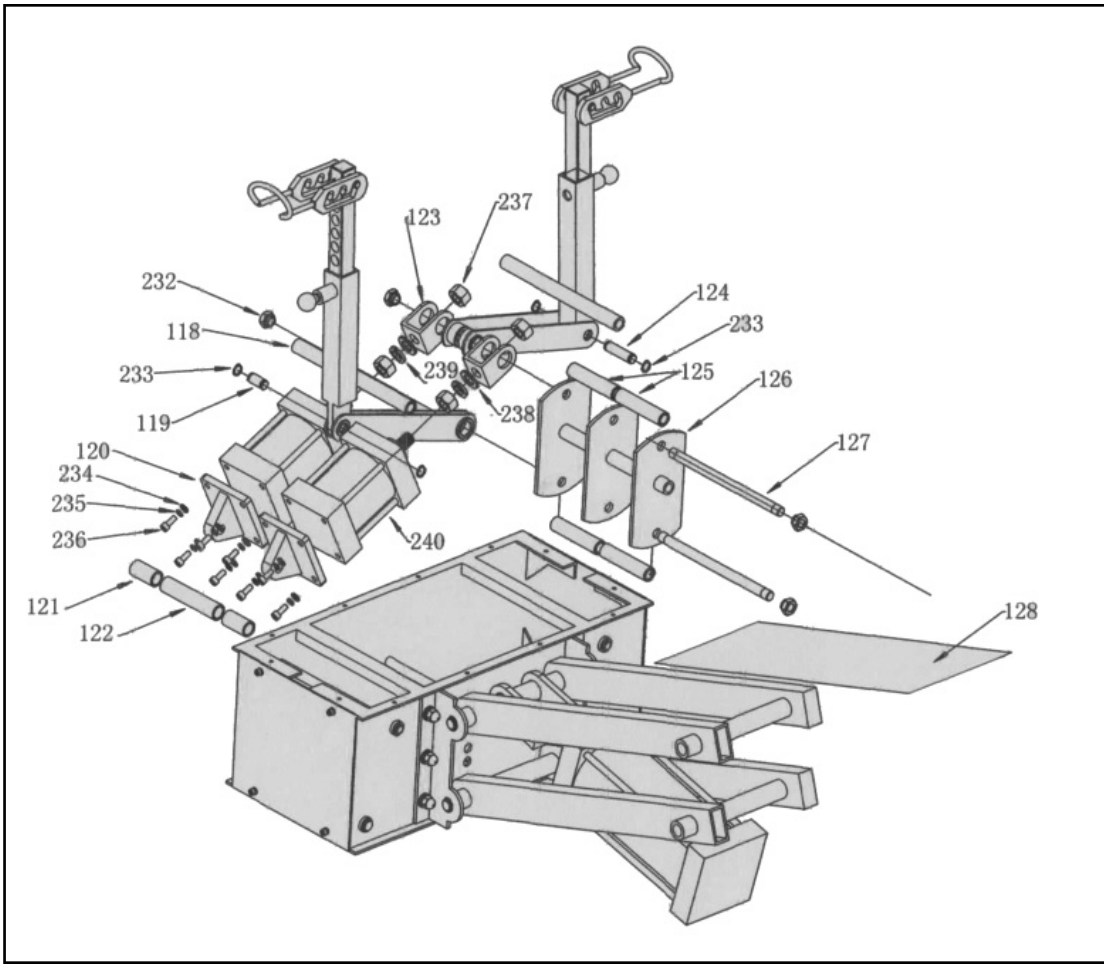

Item #	Drawing #	Description	QTY	Item #	Drawing #	Description	QTY
1	101	Valve box	1	43	229	Spring washers	6
2	201	Hand valve	2	44	230	Decorative nut	6
3	202	Door locks	1	45	115	Arm	1
4	203	Bolt	4	46	116	Arm movements earrings	2
5	204	Nut	4	47	231	Large cylinder	1
6	102	Host Box	1	48	117	Arm	
7	103	Fixed shaft	2	49	232	Locknut	4
8	205	Spring ring	4	50	118	Casing Pipe	2
9	206	Spring ring	2	51	233	Spring ring	4
10	104	Fixed shaft	1	52	119	Connecting shaft	1
11	207	Bolt	4	52	120	Small cylinder earrings	2
12	208	Spring washers	4	53	234	Pad	8
13	209	Pad	4	54	235	Spring washers	8
14	105	Large cylinder base	1	55	236	Bolt	8
15	106	Large cylinder earrings	1	56	121	Casing Pipe	2
16	210	Bolt	3	57	122	Long casing Pipe	1
17	211	Pad	3	58	123	Small cylinder earrings	2
18	212	Spring washers	3	59	237	Nut	2
19	213	Nut	3	60	238	Pad	2
20	107	Hook	2	61	239	Spring washers	2
21	214	Screw	2	62	240	Small cylinder	2
22	108	Shaft	2	63	124	Shaft	1
23	109	Sets	4	64	125	Casing Pipe	4
24	215	Handball	2	65	126	Turntable	1
25	216	Nut	2	66	127	Connecting shaft	2
26	217	Spring	2	67	128	Lid	1
27	218	Bolt	2	68	129	Wheel	2
28	219	Bolt	8	69	130	Lid	1
29	220	Spring washers	8	70	131	Connecting shaft	1
30	221	Pad	8	71	241	Bolt	8
31	110	Plate	2	72	242	Spring washers	8
32	111	Take-off and landing Box	1	73	243	Pad	4
33	112	pull pole	2	74	244	Spring ring	2
34	113	Sets	2	75	132	Connecting shaft	1
35	222	Bolt	6	76	133	Bridge approach	1
36	223	Nut	1	77	134	bridge approach wheel	2
37	224	Pad	1	78	135	Shaft	2
38	225	Spring washers	1	79	245	Spring ring	4
39	226	Nut	1	80	136	Connecting shaft	3
40	227	Spring ring	4	81	245	Spring ring	6
41	114	Connecting shaft	2	82	137	Connecting shaft	1
42	228	Pad	6	83	246	Spring ring	2



The best automotive service equipment on the planet.

**For Parts Or Service
Contact:**

**BendPak Inc. / Ranger Products
1645 Lemonwood Dr.
Santa Paula, CA. 93060**

**Tel: 1-805-933-9970
Toll Free: 1-800-253-2363
Fax: 1-805-933-9160**

**www.bendpak.com
www.rangerproducts.com**

